

IBC SNOWDRIFT

You need not be concerned with the Snow Drift information if the adjacent building is lower than the new building or if the adjacent building is greater than 20' away.

Wall Affected:

Which wall on the building you are specifying is affected: Front Sidewall, Back Sidewall, Left Endwall, or Right Endwall. For an explanation of wall names, see the Building Orientation Diagram.

Average Distance Below Adjacent Structure:

How much taller the adjacent building is than the new building.

Linear Feet Affected:

How many lineal feet of the new building is adjacent to the adjacent building.

Average Distance to Adjacent Structure:

How far away the new building is from the adjacent building.

Width of Length of Adjacent Structure:

If the adjacent structure's endwall is facing the building you are entering, specify the total length of the adjacent structure. If the adjacent structure's sidewall is facing the building you are entering, specify the total width of the adjacent structure, even if the adjacent building is a gabled building.

Example 1:

The correct information for the example below would be:

Wall Affected: Front Sidewall

Average Distance Below Adjacent Structure: 4'-0"

Linear Feet Affected: 60'-0"

Average Distance to Adjacent Structure: 2'-0"

Width of Length of Adjacent Structure: 30'-0"

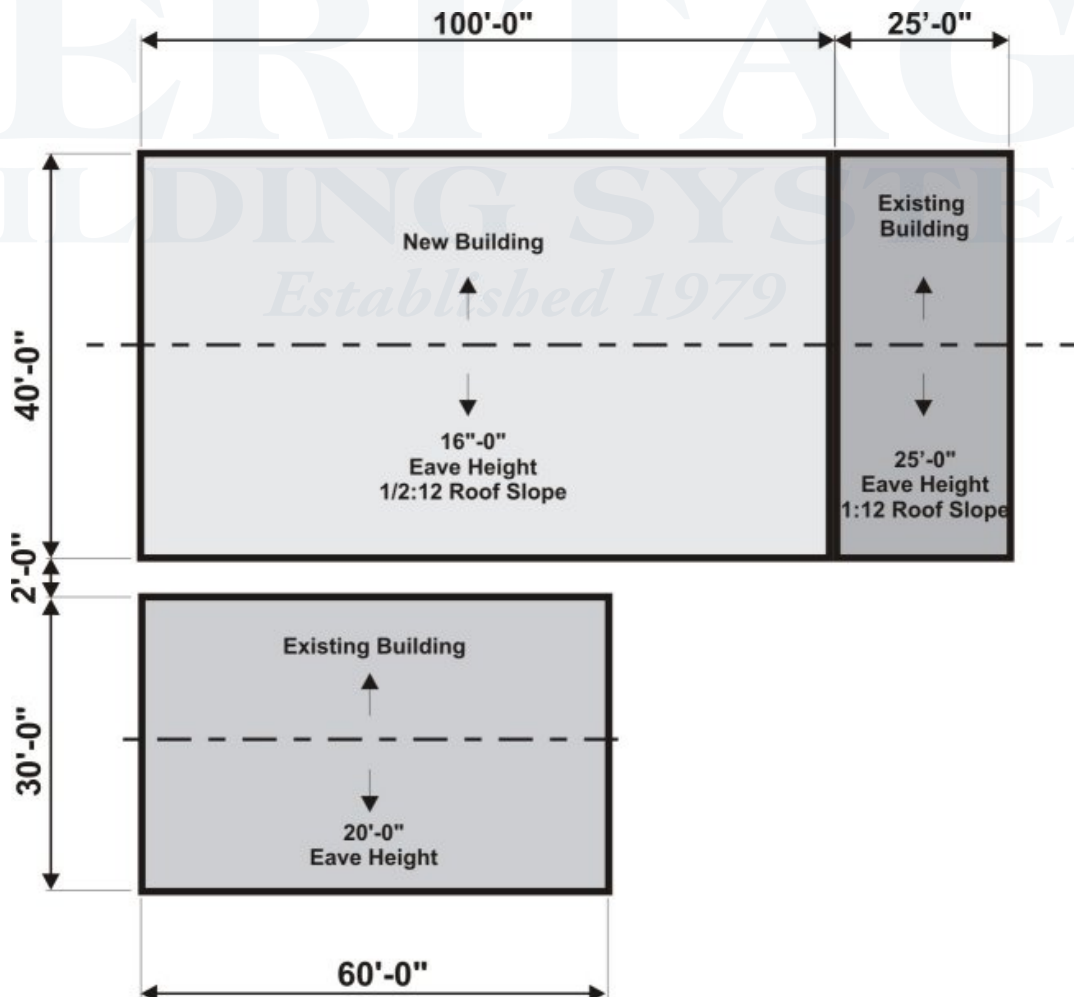

Example 2:

The correct information for the example below would be:

Wall Affected: Front Sidewall

Average Distance Below Adjacent Structure: 4'-0"

Linear Feet Affected: 30'-0"

Average Distance to Adjacent Structure: 2'-0"

Width of Length of Adjacent Structure: 60'-0"

